

PINE - INSTALLATION

PINE ACOUSTIC WALL PANEL CAN BE EASILY SCREWED OR FIXED WITH H- SPLINE OVER EXISTING WALL OR ANY FRAMEWORK.

OPTION- 1 INSTALLATION WITH H - SPLINE



H - SPLINE

PINE Wall Panel can be affixed to the wall using H -SPLINE, as follows:

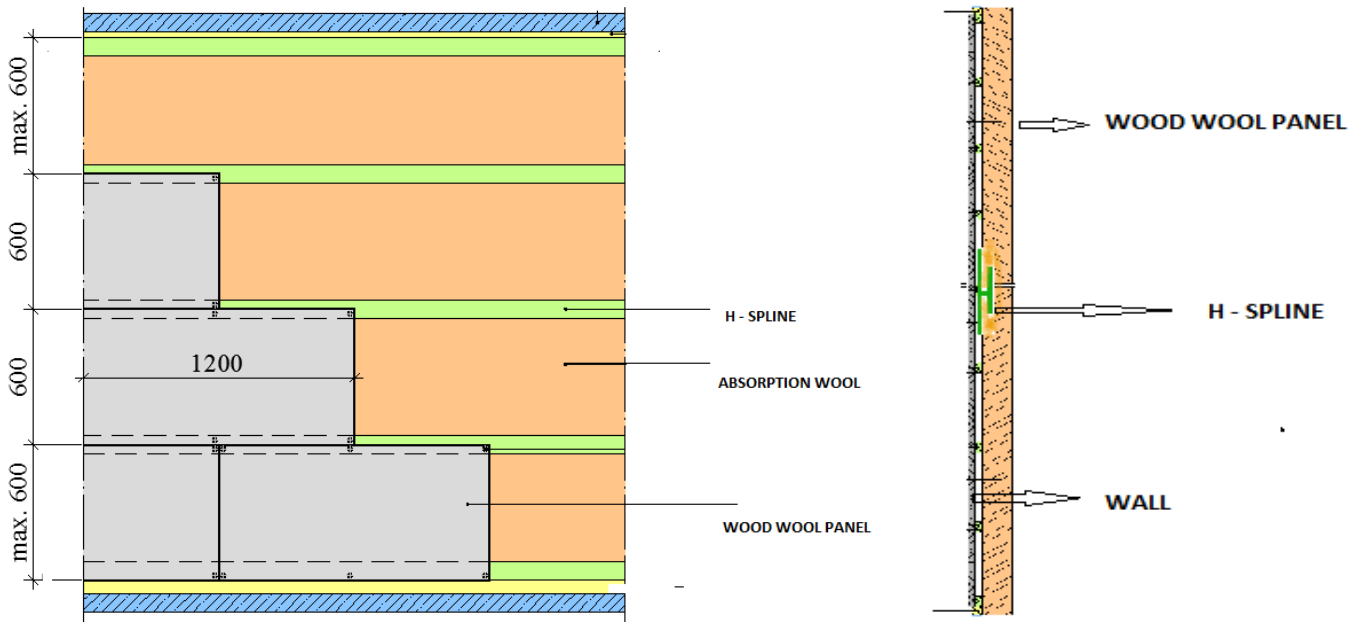

Diagram 1

Diagram 2

1. Mark the location of each H- Spline on the wall or framework & fix the H- Spline on mark location (As Shown in Diagram 1)
2. Carefully align the wall panel by inserting edge of the H-spline into the groove of the panel, and continue the process with each panel .(As Shown in Diagram 2)
3. For better acoustic performance fill the cavity (if created) between the wall & panel with the absorption wool.

OPTION- 2 INSTALLATION WITH SCREW :

1. Mark the location of each panel on the wall
2. Carefully align the wall panels on the marked location, screw near to edges of the panel, Apply same colour paint on the face of screw. (As Shown in below diagrams)
3. For better acoustic performance fill the cavity (if created) between the wall & panel with the absorption wool.

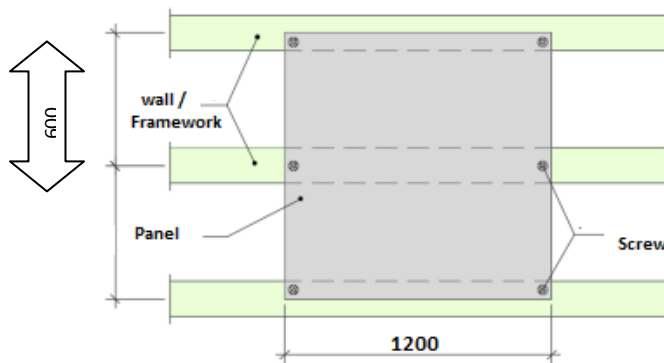

INSTALLATIONS ON CEILING:

Pine ceiling tile easily installed on metal T-grid Framework as shown in diagram.

